

draining - refilling - level : automatic gearbox BVA AL4 AND AL4 (HP16) AND AL4 AUTOMATIC GEARBOX

1 Recommended tools

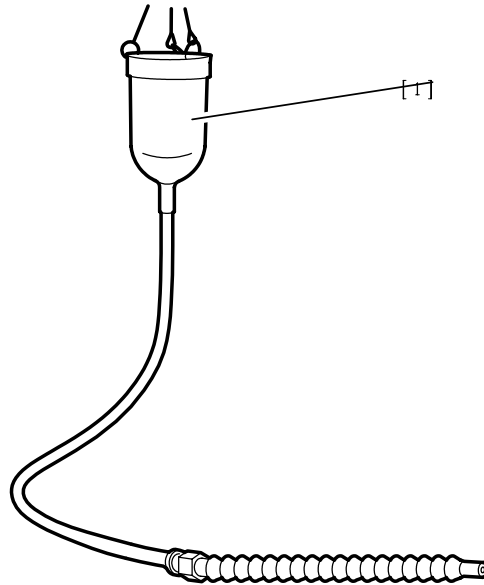

- Fig. : 1 -

[1] topping up cylinder (-) 0341.

2 Draining

CAUTION : The gearbox should be drained if repairs are carried out.

URGENT : The gearbox oil must only be drained when the oil is hot 60 °C (+ 8 °, - 2 °) to remove the impurities that are in suspension in the oil.

N.B. : The oil change is partial, since the converter cannot be totally drained.

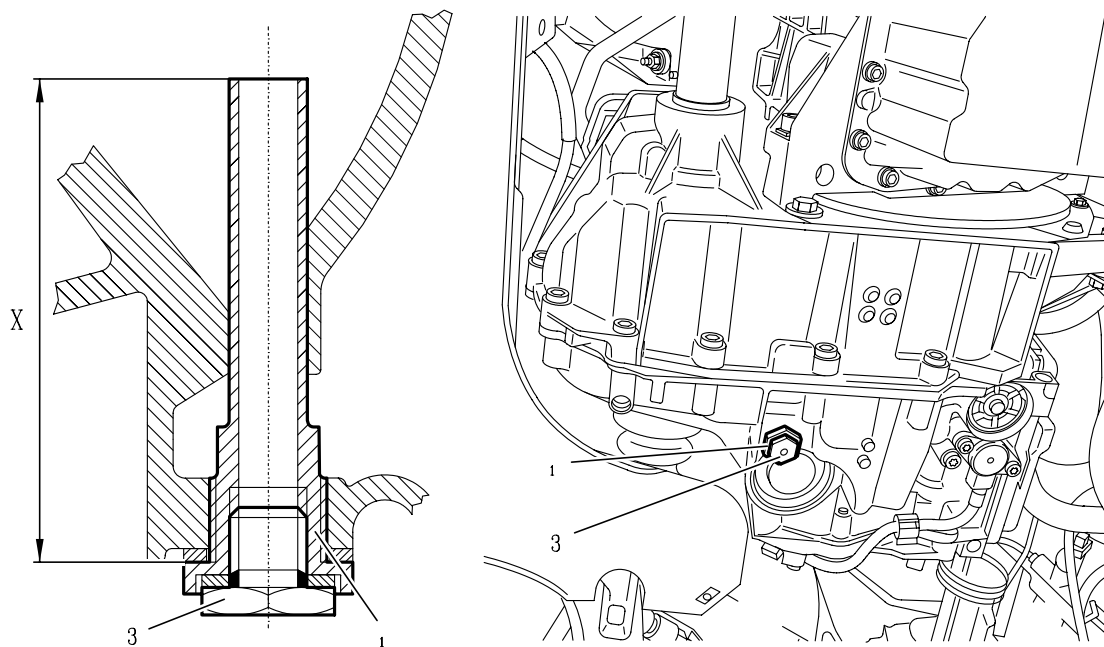

- Fig. : 2 -

Remove the drain plug (1).

CAUTION : X = 75 mm.

3 Refilling

Refit the drain plug (1) :
tighten to 3,3 m.daN.

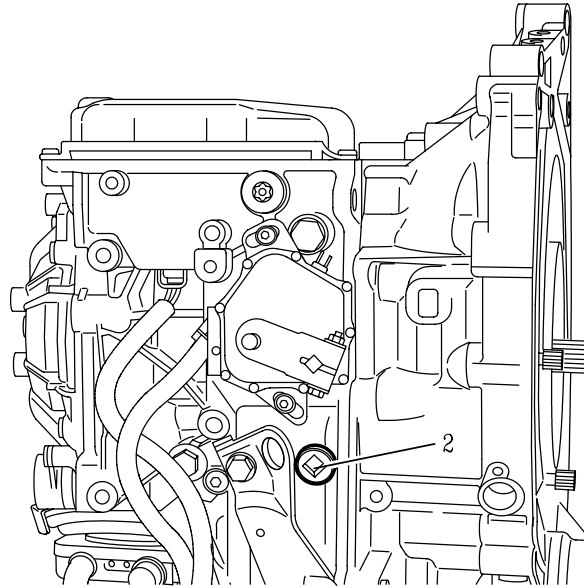

- Fig. : 3 -

Remove the filler plug (2).

Use the tool [1].

Oil capacity of a new gearbox :
6 litres.

Oil remaining after draining :
3 litres (approximately).

Quantity of oil to be replaced :
3 litres (approximately).

Refit the filler plug (2) :
tighten to 2,4 m.daN.

4 Oil level check

Prior conditions

:

- the vehicle is on a flat surface
- check that the gearbox is not in a back-up mode
- remove the filler plug (2)
- add 0,5 litre of oil to the gearbox
- apply the brakes firmly and move the lever through the various selector positions
- gear lever in position " P "
- engine running ,

at idle

- the oil temperature 60°C (+ 8°; - 2°)

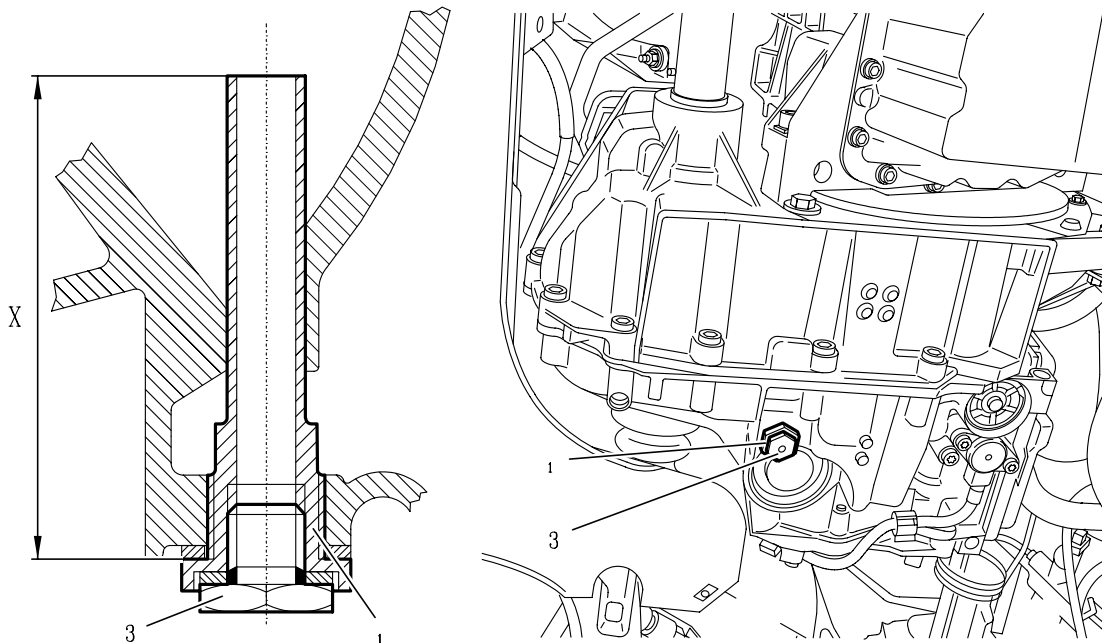

- Fig. : 4 -

Remove the oil level plug (3).

Stream of oil then reducing to a sequence of drips :

refit the oil level plug (3) .

Tighten to 2,4 m.daN.

Sequence of drips or nothing :

refit the oil level plug (3) .

Stop the engine.

Add 0,5 litre of oil to the gearbox.

Repeat the topping up procedure.

N.B. : The level is correct when the trickle of oil reduces to a slow drip.

Refit the oil level plug (3) .

Tighten to 2,4 m.daN.

Refit the filler plug (2) :

tighten to 2,4 m.daN.

If the oil level is too high, the following may occur

:

- overheating of the oil
- oil leaks

If the level is too low, the gearbox will be destroyed.

5 Precautions to be taken

5.1 Towing

It is necessary to lift up the front of the vehicle for towing it.

If it is not possible to lift up the front of the vehicle

:

- the selection lever must be in position " N "
- do not add any oil
- do not exceed a speed of 50 km/h over a distance of 50 kilometres

5.2 Driving

Never drive with the ignition switched off.

Never push the vehicle in an attempt to start it (impossible with an automatic gearbox).

N.B. : Lubrication of the automatic gearbox is ensured only when the engine is running.